

Installation Instructions

Qboard[®] liquid nova
Quality Board

Installation instructions Qboard® liquid nova

Qboard® liquid nova – System components

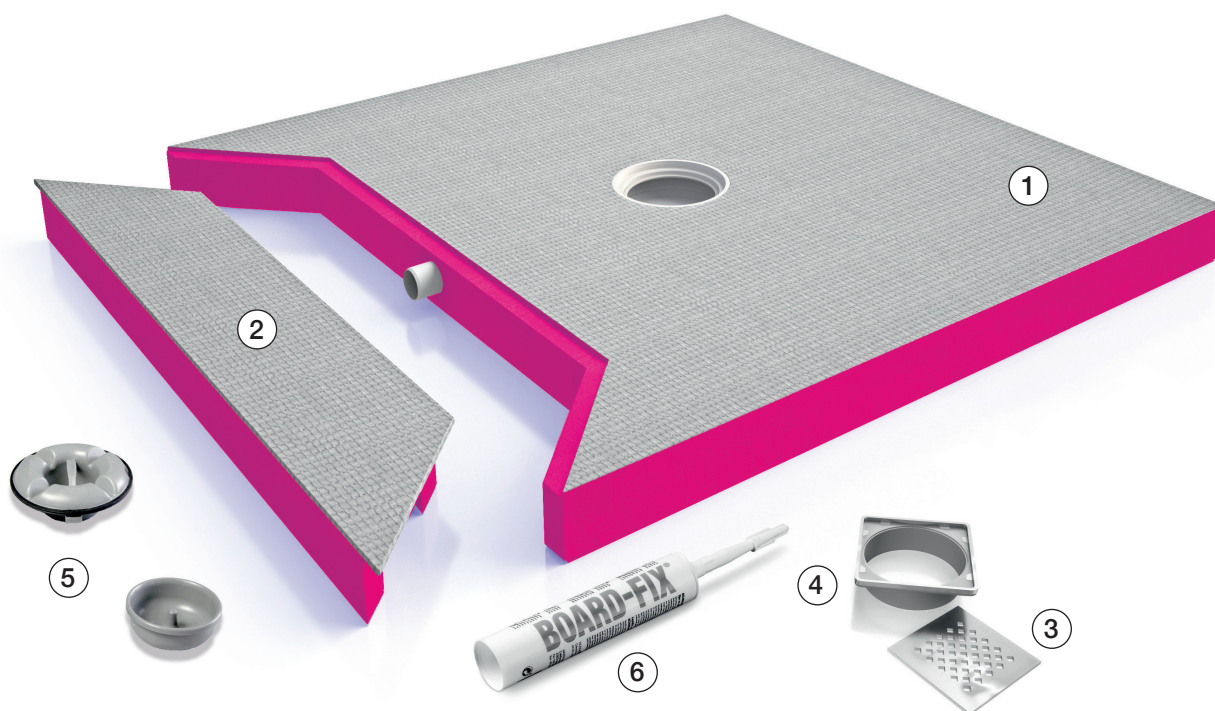

- ① Qboard® liquid nova - Shower element
- ② Qboard® liquid nova - Pipe duct element
- ③ Grate
- ④ Top piece
- ⑤ Odour trap (top and bottom sections)
- ⑥ BOARD-FIX® (special adhesive and sealing agent)

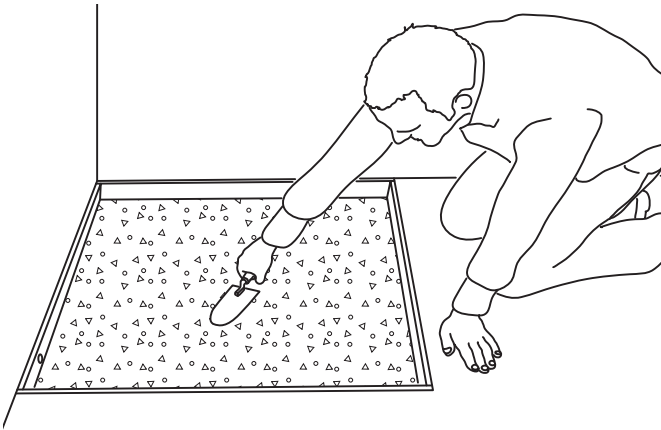

- 1) There are two possible ways to ensure the correct height of Qboard® liquid nova.
 - a) Using cement-based levelling screed. Pour the levelling screed into the recess and level off at the required height.
 - b) Using Qboard® construction boards. Cover the entire surface of the required thickness of construction board with tile adhesive and fix it into the recess.

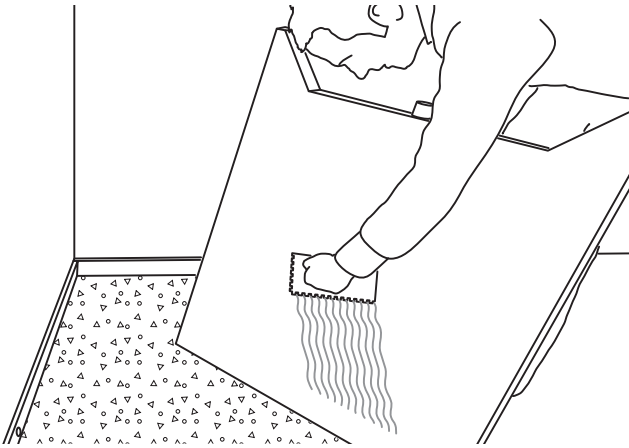

- 2) Apply tile or flexible adhesive with a notched trowel to the underside of the shower element.

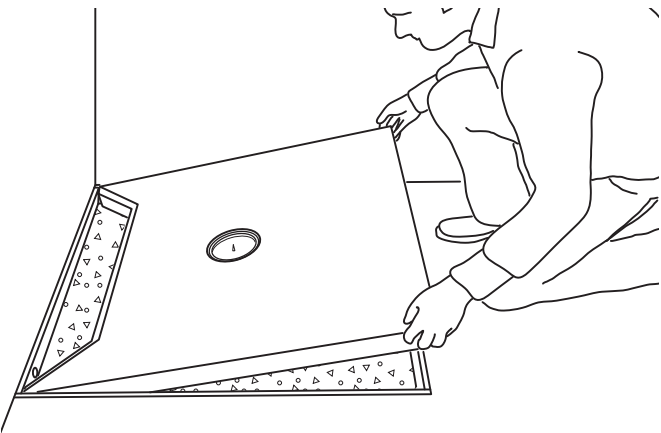

- 3) Position the shower element in the screed recess.

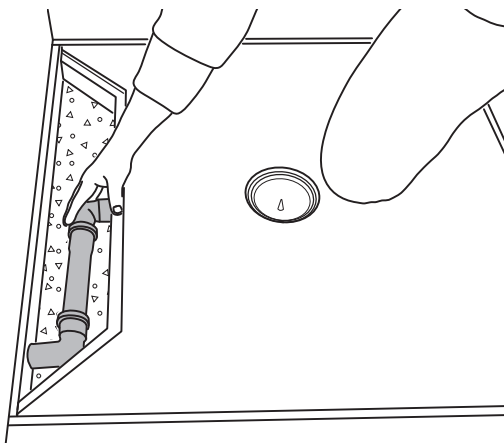

- 4) Connect the drain nozzle on the shower element (DN40) to the on-site drainpipe.

Installation instructions Qboard® liquid nova

5) On the underside of the pipe duct element (2) the break-throughs for the waste pipe be made with a cutter.

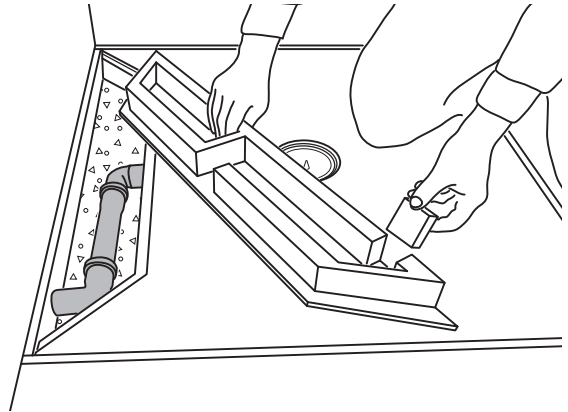

6) Apply the BOARD-FIX® (6) special adhesive and sealing agent in beads to the shiplap on the shower element. Make sure the adhesive is applied consistently, with no interruptions.

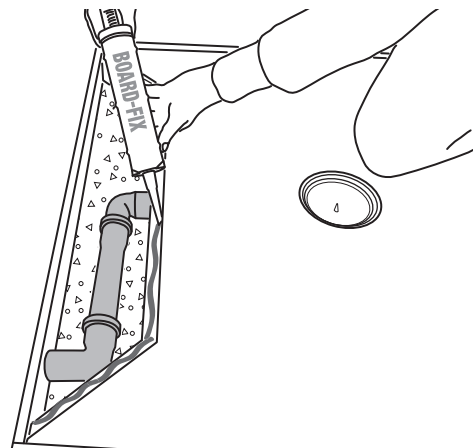

7) Then apply tile adhesive to the underside of the pipe duct element.

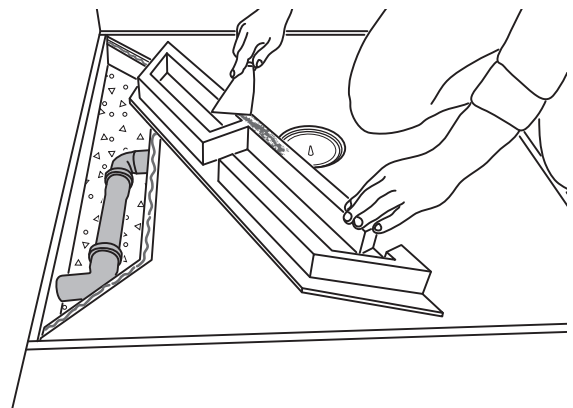

8) Position the pipe duct element (2) in the screed recess and press firmly into place. BOARD-FIX® (6) special adhesive and sealing agent guarantees the durable seal integrity of the bond.

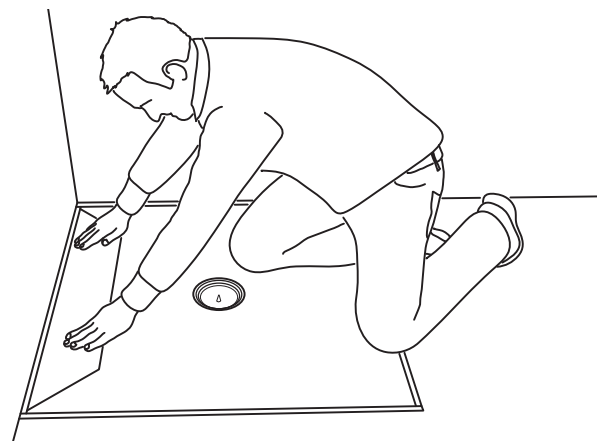

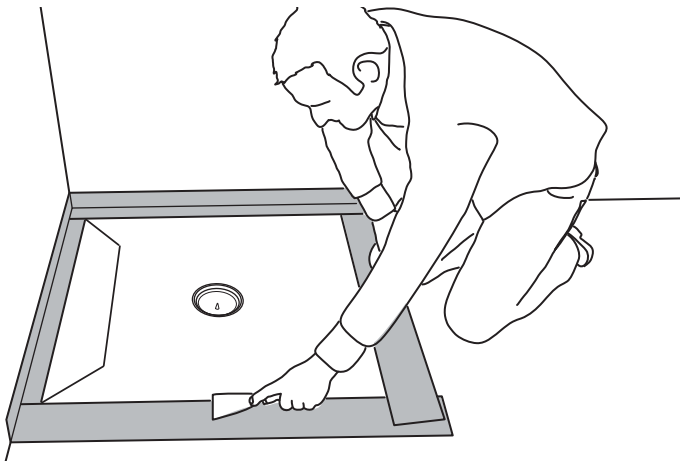

9) The connection joints to the wall and to the screed are sealed with the Qboard[®] Sealing Kit 2-k (or equivalent).

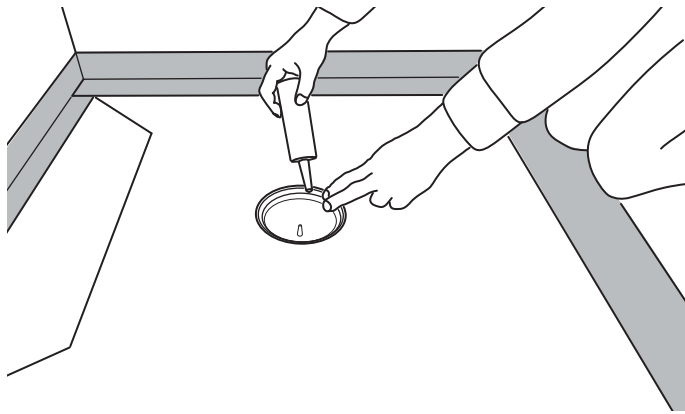

10) Before inserting the odour trap, first grease the inside edge of the drain.

Then insert the odour trap (bottom and top sections) and press firmly into place.

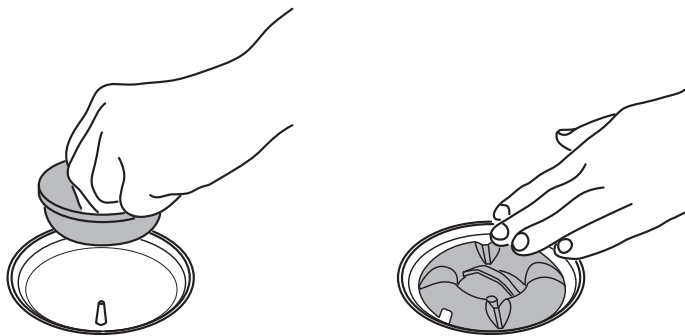

Installation instructions Qboard® liquid nova

11) Cut the top piece (4) to the right length to match the thickness of the tiles, and position in place.

Use tile adhesive in the four corners to adjust the top piece (4) to exactly the right height.

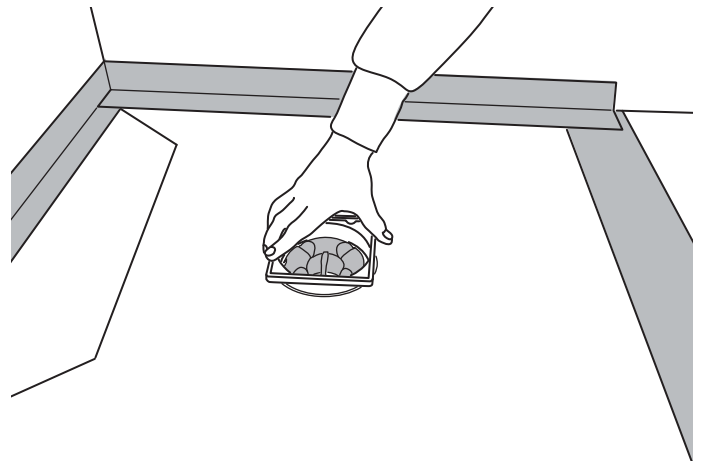

12) Position the grate (3) in place. The shower element is ready for tiling.

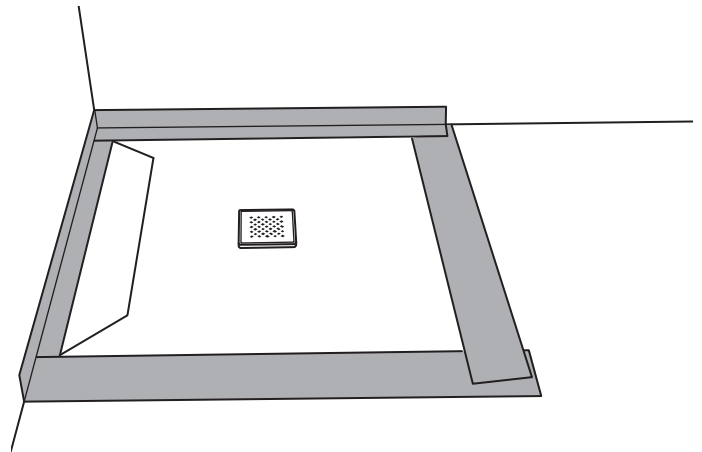

Notes for laying tiles and boards on Qboard® liquid nova:

Qboard® liquid nova is immediately tileable. All types and sizes of tiles can be used in principle. Special requirements only apply to mosaic tiles ≤ 25 mm. In such cases, we recommend using epoxy resin grout for the tile joints. If showers are to be wheelchair-accessible, they must be covered with tiles measuring $\geq 50 \times 50$ mm.

Qboard® liquid nova – Floor-level installation

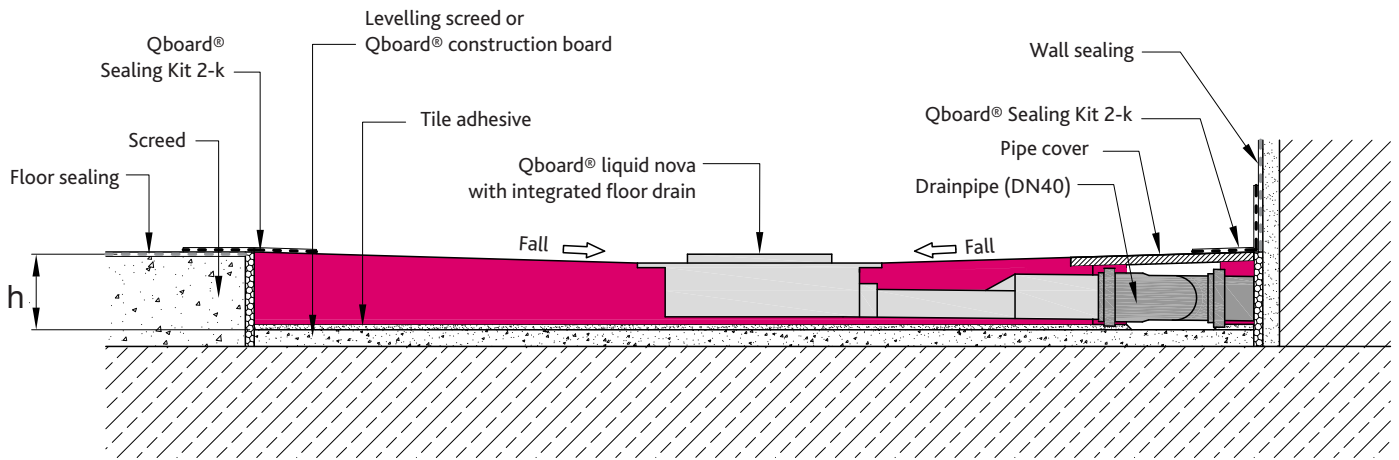

Min. installation height (h) = Qboard® liquid nova (65, 70, 75 bzw. 80 mm) + 5 mm tile adhesive

Qboard® liquid nova – Structure with step on existing screed in older buildings

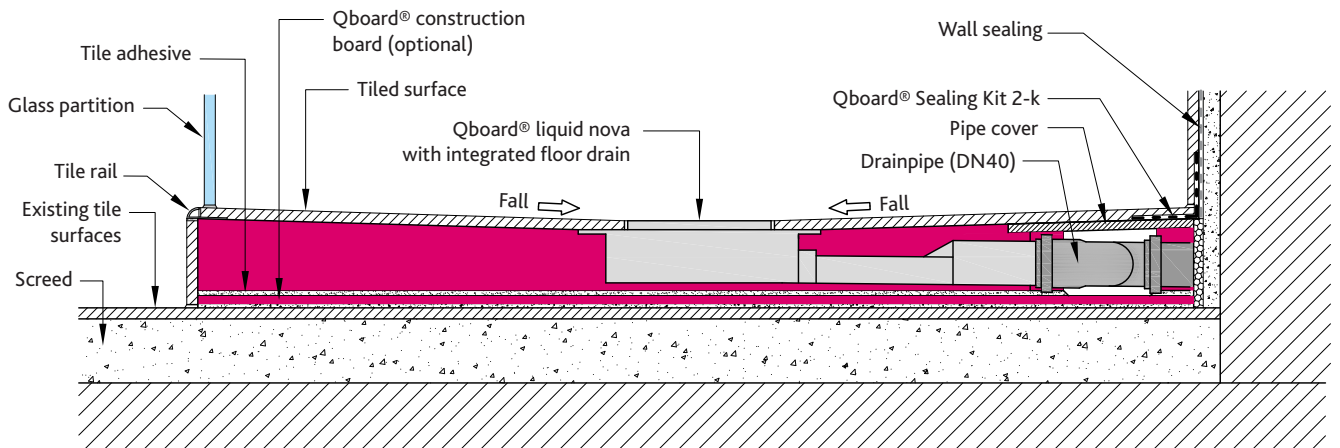

Installation instructions Qboard® liquid nova

Please note

The information in this publication is based on our current knowledge and experience. They are not guarantees in the legal sense. During application, the specific conditions of the use case must always be taken into account, especially in terms of building physics, structural engineering and building regulations.

Qboard® is a registered trademark of JACKON Insulation GmbH. Errors and omissions excepted; subject to change.
JACKON Insulation GmbH • Carl-Benz-Straße 8 • D-33803 Steinhagen • Telefon +49 5204 9955-0 • Telefax +49 5204 9955-400
info@myqboard.com • www.myqboard.com