

# A BEAUTIFUL BATHROOM. MADE BY YOU.

*With the Qboard® construction board system!*



**Qboard®**



# Applications



Page 04

## Floor application

A stable floor for every need.



Page 14

## Pre-wall elements for WCs

The kit for quick cladding.



Page 06

## Wall application

A perfect substrate for any covering.



Page 15

## Bath panelling

Variable thanks to adjustable feet.



Page 09

## Pipe cladding

Easily done with prefabricated angles.

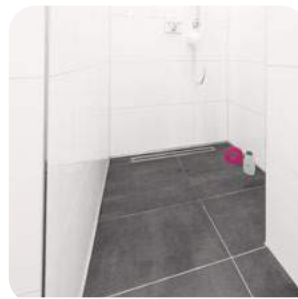

Page 16

## Floor-level showers

Lots of versions of a safe system.



Page 10

## Partition walls

Stable and flexible room redesigns.



Page 18

## Bench

The flexible construction board adapts to your needs.



Page 12

## Niches

Make space where you need it.



Page 20

## Washstand

The right washstand for every bathroom.

## Products & accessories



Page 22

### Construction boards



Page 26

### Shower elements



Page 24

### Cladding elements



Page 28

### Accessories

## Bathroom renovation with Qboard® construction boards.

Qboard® is the construction board system for DIY enthusiasts that was developed especially for bathroom renovations. You can use Qboard® to create the perfect substrate for any surface finishes: straight walls, level floors, cladding for pipes or WC elements. You can even build furniture with the construction board system. Qboard® has been on the market for over 10 years now, and lots of bathrooms have already been renovated with Qboard®.

Qboard® elements consist of a waterproof XPS (extruded rigid polystyrene foam) core with a coating of mortar and fibreglass fabric on both sides. The construction boards are available in various thicknesses and are very easy to work with using conventional tools.

When will you renovate your bathroom with Qboard®?  
**Qboard® Simply do it!**

### Features:

- Easy to work with
- Waterproof
- Can be covered directly with tiles, filler or plaster
- Lightweight, approx. 3 – 6 kg/m²
- High compressive strength > 200 kN/m²
- Excellent thermal insulation properties  $\lambda = 0.035 \text{ W/(m}\cdot\text{K)}$
- For rooms exposed to high levels of moisture



## Qboard® basiq – A stable floor for every need.

When renovating your bathroom, the first thing you need is a level floor.

You can use Qboard® basiq on different substrates, whether screed, concrete, wood or old tiles.

The high compressive strength of Qboard® basiq means that, even with a thickness of just 10 mm, it is the perfect substrate for a new floor covering.

Qboard® construction boards are temperature resistant up to 75 °C. Electric underfloor heating systems can be laid directly onto the construction boards with filler.

Qboard®'s excellent thermal insulation prevents heat from being dissipated downwards.



From practical experience: uneven floor after tile removal.



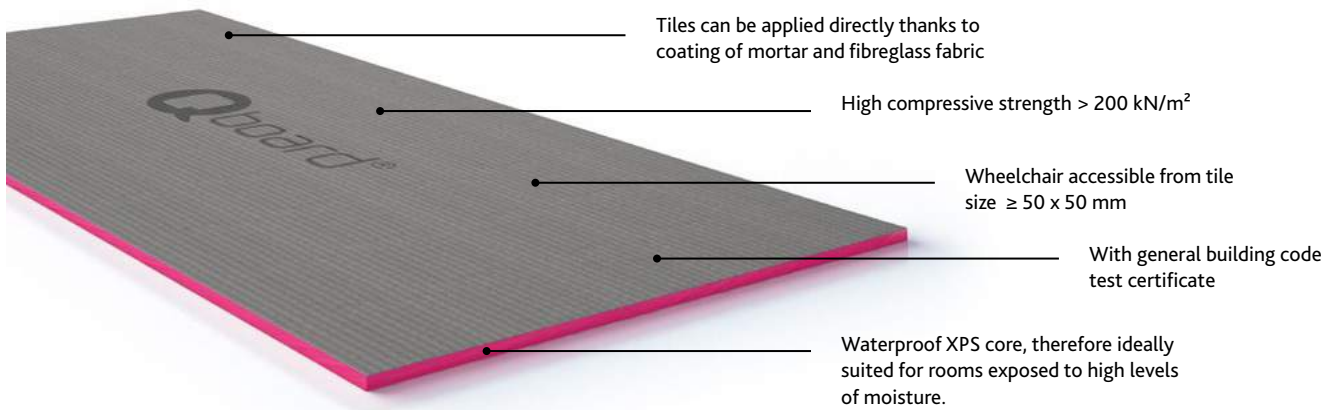

## You will need:

- Qboard® basiq [p. 22]
- Qboard® glass-fibre tape or sealing tape [p. 29]



Go to  
installation  
instructions



## Simply do it!

1.

The substrate should be clean, stable and able to take adhesive, and should be painted with a suitable primer if necessary. Spread tile or flexible adhesive over the whole area with a notched trowel.



2.

The Qboard® basiq must now be bedded into the adhesive by moving it gently back and forth.



3.

Use Qboard® glass-fibre tape to smooth over all the construction board joints. In wet areas (e.g. showers) Qboard® sealing tape should be used.



4.

Allow the tile adhesive to harden before you start laying the tiles.



## Qboard® basiq – A perfect substrate for any covering.



With Qboard® basiq, you can create neat and even wall surfaces, in addition to insulating the room and therefore permanently protecting the masonry from moisture. The mortar-coated surface forms an ideal adhesive substrate to which tiles, filler or plaster can be applied directly.

With spot bonding, Qboard® basiq with a thickness of 20 mm or more should be used, with full-surface bonding, 4 mm or more.

### You will need:

- Qboard® basiq [p. 22]
- Qboard® metal dowels [p. 28]
- Qboard® glass-fibre tape or sealing tape [p. 29]

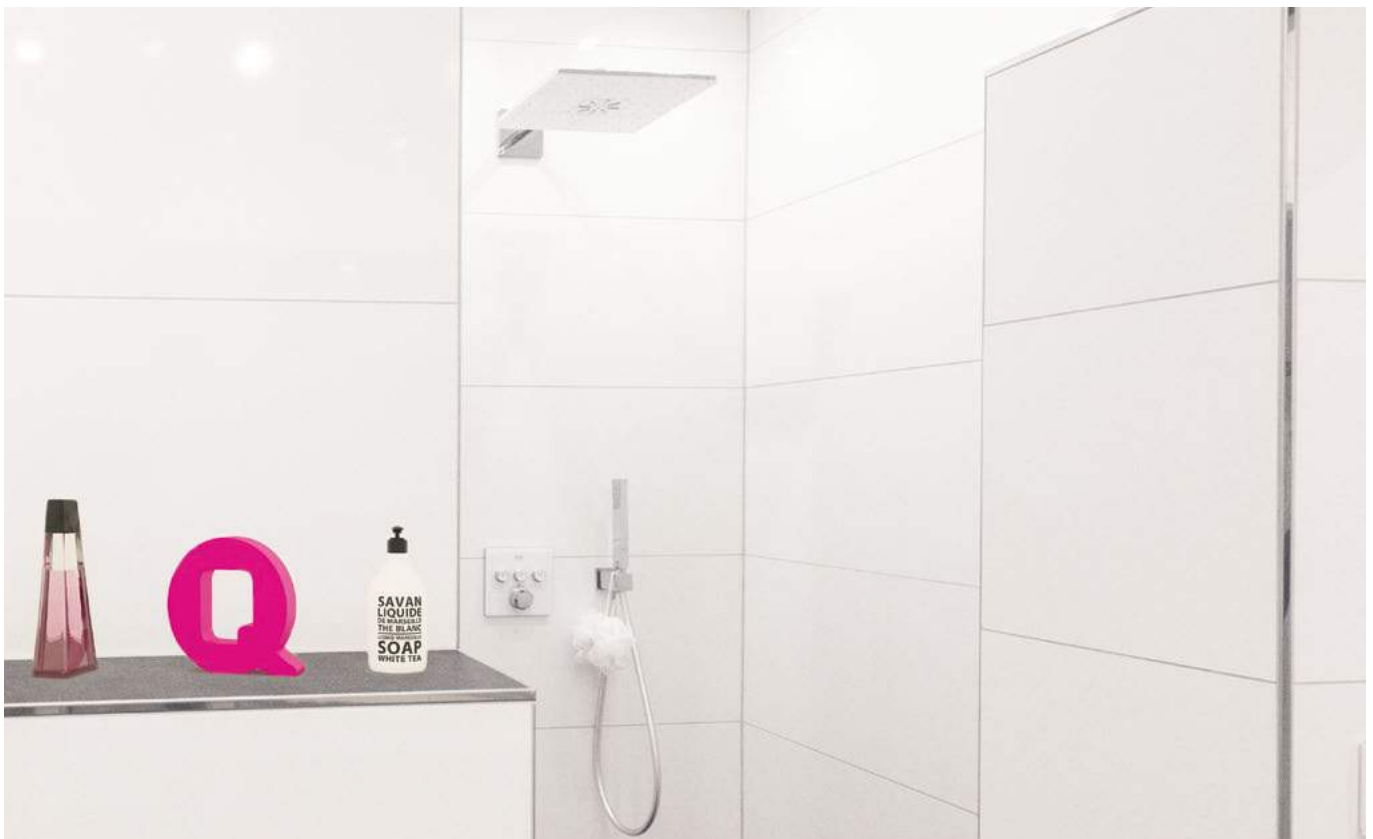



It can be covered directly with tiles, filler or plaster, thanks to its coating of mortar and fibreglass fabric.

Thermally insulating  
 $\lambda_D = 0.034 \text{ W/(m}\cdot\text{K)}$

Waterproof XPS core, therefore ideally suited for rooms exposed to high levels of moisture.

## Qboard® tip

When installing fixtures, they should be fixed into the wall behind the Qboard® or into installation frames.

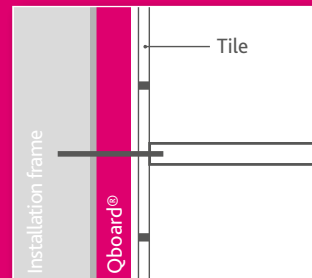
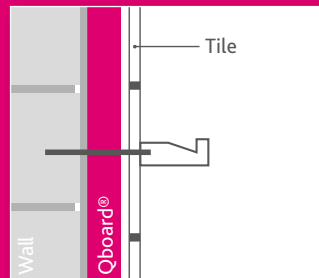

Go to  
 installation  
 instructions



## Simply do it!

1.

If walls are uneven, you first need to spot fix the construction board. Use tile or flexible adhesive to do this. The layout of the fixing spots can be found in our installation instructions.



2.

Affix the Qboard® basic construction board to the wall so that you get an even, plumb and flush substrate to work on.

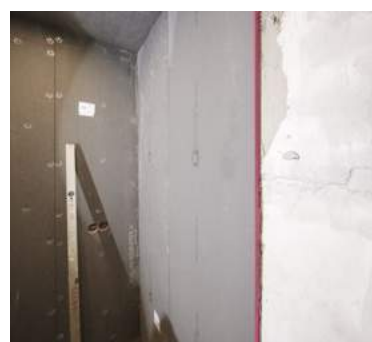

3.

Once the dabs of mortar have hardened, drill holes for fixing the construction board with Qboard® metal dowels later.



4.

Finally, you need to tape over all the board joints with self-adhesive Qboard® glass-fibre tape and smooth tile adhesive over it. In wet areas (e.g. showers) use Qboard® sealing tape.









# Qboard® qorner – the angle element for pipe cladding.

The Qboard® qorner angle element (with mortar-coated surface) is the perfect solution for quickly cladding pipes in a bathroom.

The prefabricated elements save cutting individual boards to size and gluing them and are simply attached to the wall. The perfect way to hide away thin water pipes through to large fall pipes.

You will need:

- Qboard® qorner [p. 23]
- BOARD-FIX® or Qboard® anchor brackets [p. 28]



*Simply do it!*

1.

Cut the Qboard® qorner to the required length. If you are using a jack saw or electric jig saw, we recommend one with fine teeth ( $\geq 9$  TPI).



2.

You can use Qboard® qorner either vertically or horizontally.

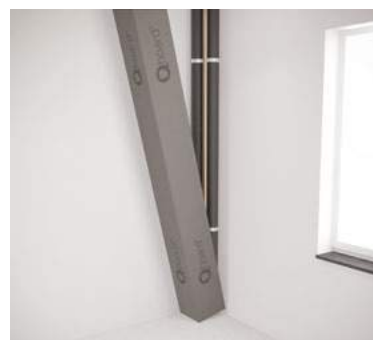

3.

To install, plug and bolt Qboard® anchor brackets onto the angle element in pairs spaced max. 80 cm apart.

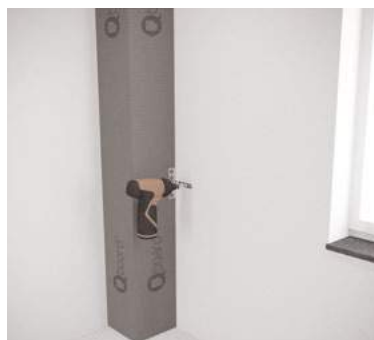

4.

Alternatively, you can also glue Qboard® qorner in place using BOARD-FIX®.



## Qboard® basiq – Stable and flexible room redesigns.

Partition walls reshape the space. With the stable Qboard® basiq construction board, you can create partition walls in no time at all. As a partition in the WC area, as part of the shower enclosure or in combination with a washstand.

They can be finished to match the rest of the bathroom with tiles, plaster, filler or paint.

And you can even build a niche into them if you need one.

This is what you need for a studwork construction:

- Qboard® basiq [p. 22]
- Qboard® insulation board discs [p. 28]
- Qboard® glass-fibre tape or sealing tape [p. 29]



### Qboard tip

Use self-tapping metal-plate screws for metal studwork and standard universal screws for timber studwork.

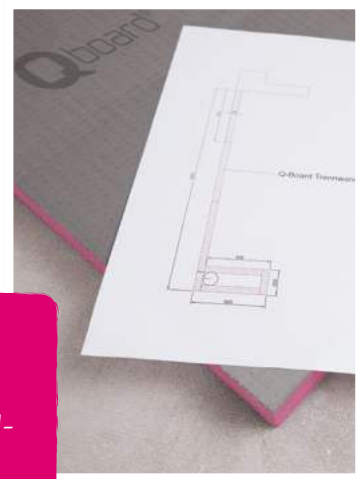

With Qboard® you have a choice. You can either build your partition wall with studwork or use Qboard® basiq and Qboard® H and U profiles.

For studwork with a frame spacing of up to 30 cm, you will need Qboard® with a thickness of at least 10 mm; if the frame spacing is up to 60 cm, you will need a thickness of at least 20 mm. If you build a partition wall with H and U profiles, you will need a thickness of 50 mm.

**You will need: (construction with H and U profiles)**

- Qboard® basiq [p. 22]
- Qboard® H and U profiles [p. 28]
- BOARD-FIX® [p. 28]
- Qboard® glass-fibre tape or sealing tape [p. 29]



Go to  
installation  
instructions



## Simply do it!



**1.**  
First, fix the Qboard® U profiles to the wall and floor with standard universal screws.



**2.**  
Apply BOARD-FIX® to the wall and floor to which the partition wall is to be connected later.



**3.**  
Then glue the construction board to the wall and floor. Position further construction boards with BOARD-FIX® and two H profiles on either side of each construction board and another U profile on the floor.



**4.**  
Finally, you need to tape over all the board joints with self-adhesive Qboard® glass-fibre tape and smooth tile adhesive over it. In wet areas (e.g. showers) use Qboard® sealing tape.



# Qboard® – Make space where you need it.

Think about niches and shelf space as soon as you start planning your bathroom renovation.

With Qboard® you can integrate them into the walls – in the exact size and at the exact height that you need. For example, as a shelf in the shower or as a storage space for towels.

**You will need:**

- Qboard® basiq [p. 22]
- BOARD-FIX® [p. 28]
- Qboard® glass-fibre tape or sealing tape [p. 29]



e.g. a niche for  
bathroom utensils

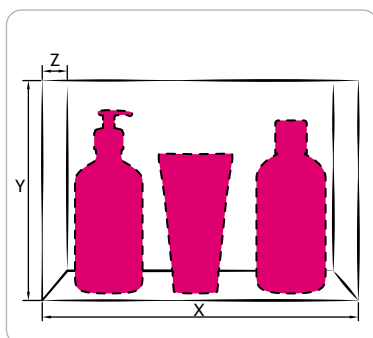

or toys

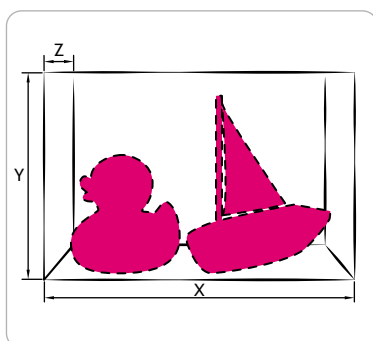

or drinks

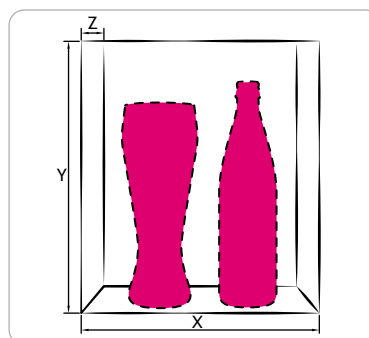

or made to measure  
just for you!

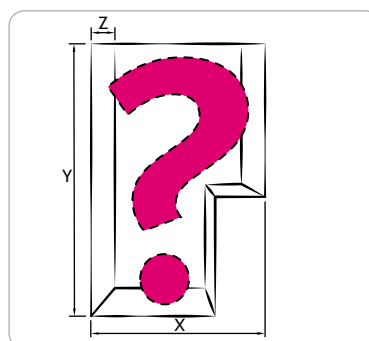

## Simply do it!

1.

First mark the niches on the front board and then cut out the openings with a cutter or saw.



2.

Build an appropriate substructure and apply BOARD-FIX® in strings.



3.

Screw the front board and substructure together to fix the bond.

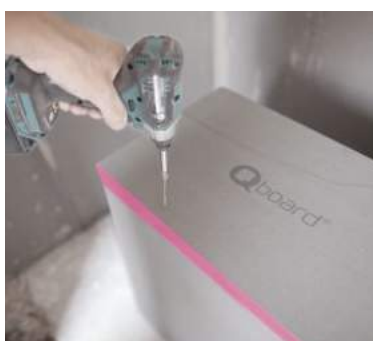

4.

Finally, you need to tape over all the board joints with self-adhesive Qboard® glass-fibre tape and smooth tile adhesive over it. In wet areas (e.g. showers) use Qboard® sealing tape.



## Qboard® quick – The kit for quick cladding.

You don't have to reinvent the wheel to clad a WC – just use our Qboard® quick assembly kit. The prefabricated system already has suitable holes for the WC connections and is installed in just a few steps. Qboard® quick can be used for all standard toilet connections.

The Qboard® quick kit contains:  
3 special elements, 10 insulation board discs and  
10 self-tapping screws

You will need:

- Qboard® quick [p. 24]
- BOARD-FIX® [p. 28]
- Qboard® glass-fibre tape [p. 29]



*Simply do it!*

1.

Cut the Qboard® quick to the required length. Then cut out the hole for the flush plate.



3.

Now cut the side elements to size and glue them on using BOARD-FIX®.



2.

You can mount Qboard® quick onto the steel frame of the WC wall element using self-tapping screws and Qboard® insulation board discs.



4.

Finally, you need to smooth over the butt joints and edges with Qboard® glass-fibre tape.

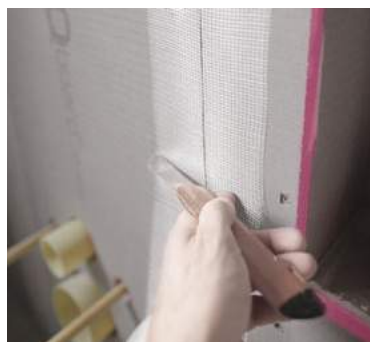



# Bathtubs in good shape thanks to Qboard® qladd.

Putting a bathtub into a bathroom? We make panelling easy for you – with Qboard® qladd. The construction boards are fitted under the rim of the bath and made totally waterproof in just a few steps.

Tile the material to suit your taste and the bathtub will become the highlight of your renovated bathroom.

## You will need:

- Qboard® qladd [p. 24]
- BOARD-FIX® [p. 28]
- Qboard® glass-fibre tape [p. 29]



*Simply do it!*

- 1.**  
Cut the Qboard® qladd to the desired height and length and apply BOARD-FIX® to the long and short side.



- 3.**  
Unscrew the height-adjustment piece on the feet with a spanner or wrench until the Qboard® qladd sits tight underneath the rim of the bath.



- 2.**  
Place the elements underneath the rim of the bath and position them. The height-adjustable feet allow you to easily level out unevenness in raw concrete or screed during installation.



- 4.**  
Once all the board joints and visible front edges have been smoothed over with Qboard® glass-fibre tape, you can lay tiles directly onto Qboard® qladd.



## Qboard® liquid – Lots of versions of a safe system.

Qboard® liquid shower elements combine looks and functionality. Every element can be tiled straight after installation. The components have a built-in fall so water can flow away optimally.

Together with Qboard® construction boards, they can easily be used to construct a complete shower. You can even produce your individual design elements such as niches, shelves and seats neatly, easily and quickly with Qboard®.

### You will need:

- Qboard® liquid / Qboard® liquid line [p. 26]
- Qboard® drain system, vertical or horizontal [p. 27]
- Qboard® sealing tape or Qboard® sealing set [p. 29]

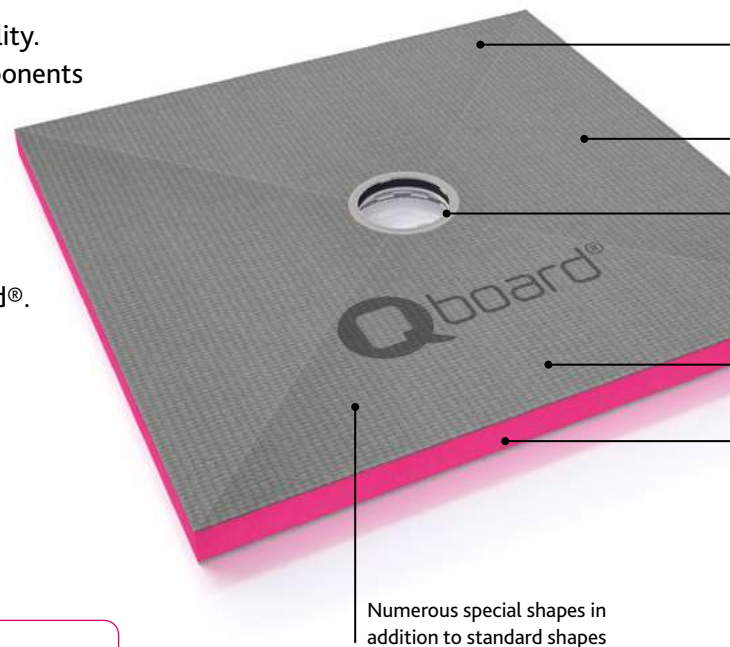

*Simply do it!*

1.

Connect the floor drain to the drainpipe and adjust the height.



2.

Fill in the screed recess with cement-based levelling screed and trowel it up to the corresponding height.



3.

Apply adhesive to the entire surface of the shower element and bond to the hardened levelling screed. Use a tile or flexible adhesive for this.



4.

Seal all joints with Qboard® sealing set.



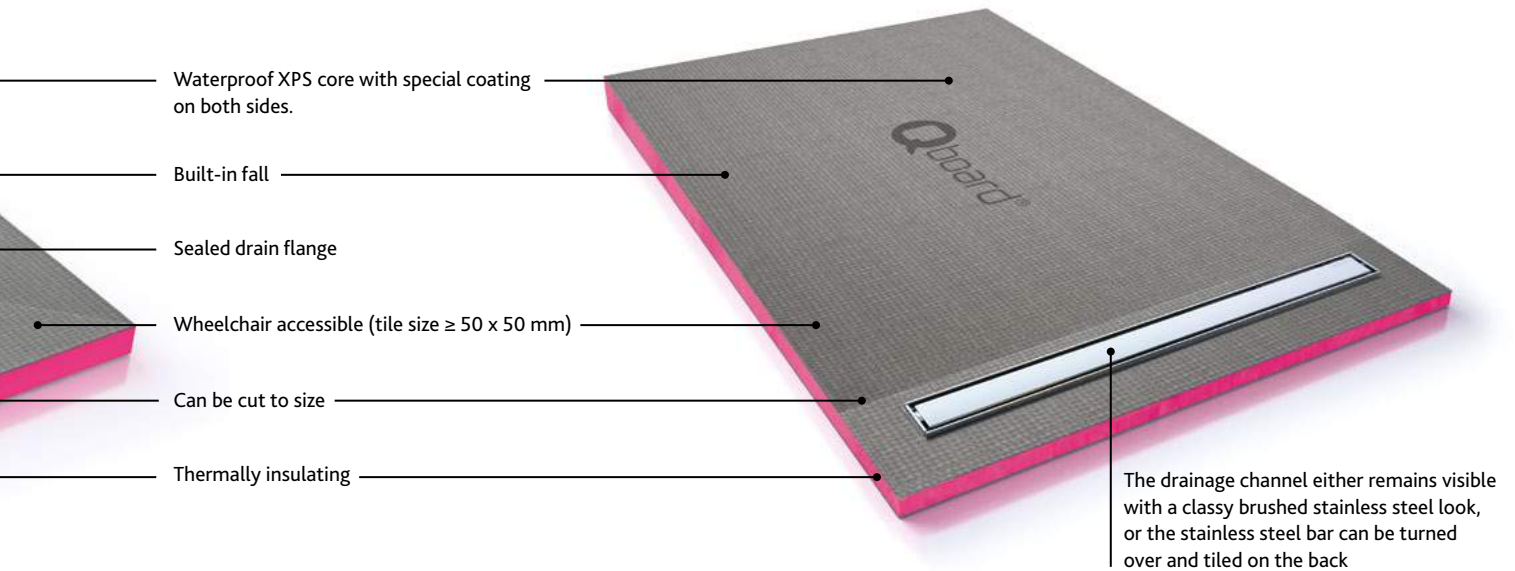

Go to  
installation  
instructions

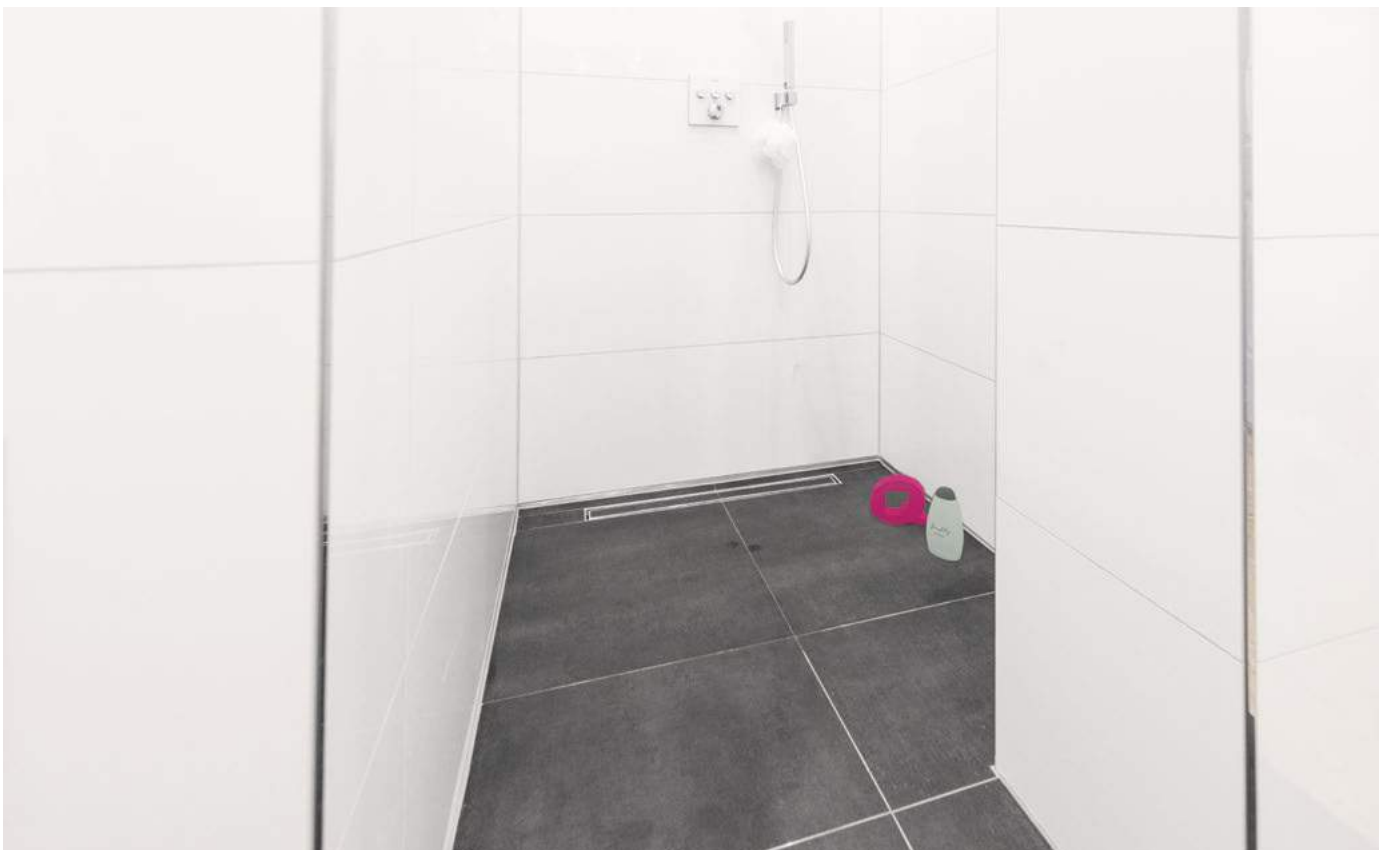



## Qboard® qreative – The flexible construction board adapts to your needs.

Create your bathroom furniture just how you want it with Qboard® qreative. Design seats and shelves with organic and fluid shapes. And all without laying a brick – simply cut to size. The special feature: bathroom furniture made of Qboard® can withstand moisture and wet conditions.

If building seats in wet areas (e.g. showers), the entire seat must be covered with a suitable liquid composite seal before tiling.

### You will need:

- Qboard® basiq [p. 22]
- Qboard® qreative [p. 22]
- BOARD-FIX® [p. 28]
- Qboard® glass-fibre tape or sealing tape [p. 29]



### Qboard® tip

*For internal curves, we recommend gluing Qboard® qreative with the slit side facing up. The open slits must then be filled with tile adhesive using a reinforcement weave.*



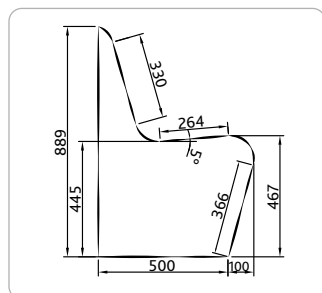

straight foot with backrest

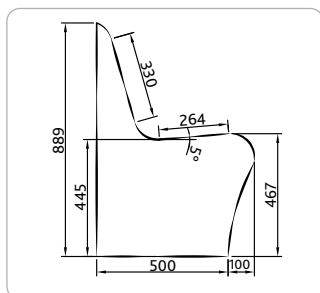

curved foot with backrest

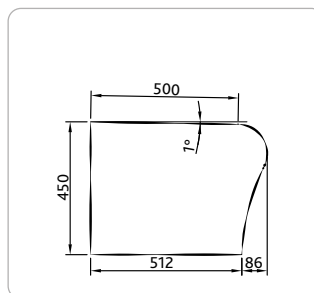

curved foot without backrest

You can find downloadable 1:1 scale templates for other bench shapes on our [www.myqboard.com](http://www.myqboard.com) website.



The smallest internal bending radius of Qboard® qreative is 90 mm.

## Simply do it!

1.

First, make a substructure for the bench out of 50 mm thick Qboard® basiq. The components must be exactly the same size so that the bench rests firmly on every element leaving no cavities.

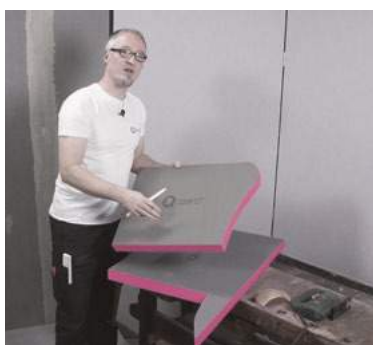

2.

Space the sawn elements about 35 cm apart and glue them to the wall and floor using BOARD-FIX®.



3.

Glue the Qboard® qreative to the substructure with the slit side facing down using BOARD-FIX®. For inner radii, we recommend turning the construction board over so that the slit side is facing up.



4.

Fix the Qboard® qreative to the substructure additionally with standard universal screws (6 x 120 mm). Here too, you should smooth over all butt joints and front edges with Qboard® glass-fibre tape.



## Qboard® – The right washstand for every bathroom.

Round or rectangular, tiled or plastered, Qboard® makes anything possible. So you can build your own bespoke washstand.

The construction board should be at least 50 mm thick.

You will need:

- Qboard® basiQ and possibly Qboard® qreative [p. 22]
- BOARD-FIX® [p. 28]
- Qboard® glass-fibre tape or sealing tape [p. 29]





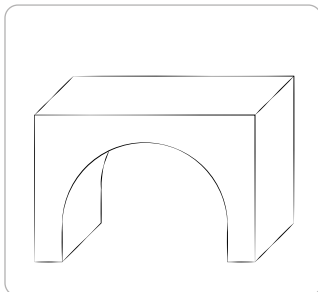

Washstand with round curve

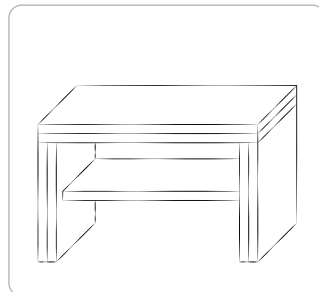

Washstand with classic shape

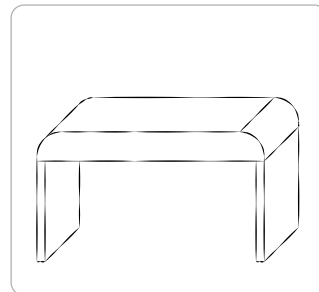

Washstand with rounded edges

## Qboard tip

To make it easier to cut the tiles to size, first select the tiles and then work out the dimensions of the washstand.

## Simply do it!

1.

Cut the Qboard® construction boards to the desired size. Use BOARD-FIX® to glue the cut elements together.



3.

Glue and screw the top piece of the washstand as described above.



2.

Also screw the side panels together to make them stable. We recommend using standard universal screws (6 x 120 mm) for this. The heads of the screws should be flush with the surface.



4.

Once you have taped Qboard® glass-fibre tape over the joints and edges and covered them with filler, you can apply your chosen surface finish.



**Qboard® basiQ**



**Qboard® basiQ** construction boards are the basic construction board for use on walls and floors. With thicknesses of 30, 40, 50 and 80 mm, Qboard® basiQ is ideal for building bathroom furniture.

Length (mm)	Width (mm)	Thickness (mm)	Item no.	EAN
1200	600	4	4507385	4025345064988
		6	4507386	4025345064995
		10	4507387	4025345065008
		12.5	4507388	4025345065015
		20	4507389	4025345065022
		30	4507390	4025345065039
		40	4507391	4025345065046
		50	4507360	4025345064698
2600	600	80	4507361	4025345064704
		10	4507362	4025345064711
		12.5	4507363	4025345064728
		20	4507364	4025345064735
		30	4507365	4025345064742
		40	4507366	4025345064759
		50	4507367	4025345064766
		80	4507368	4025345064773

**Qboard® qreative**



Create any curve you want with bendable **Qboard® qreative** construction boards. With slits already made at the factory, it is particularly suitable for seats or undulating partition walls. Can be covered directly with tiles, filler or plaster.

Length (mm)	Width (mm)	Thickness (mm)	Item no.	EAN
1300	600	30	4507409	4025345072747

(cross-slotted / VE = 2 Qboard® qreative boards in a box)



## Qboard® basiq nf



**Qboard® basiq nf**, the construction board with a tongue and groove system for easy and stable connection of construction board joints for a wide range of applications. Qboard® basiq nf is supplied with 2 tongues measuring 1300 x 37 x 6 mm.

basiq nf-2

Length (mm)	Dimensions (mm)	Thickness (mm)	Item no.	EAN
2600	600	50	4511928	4025345096217

basiq nf-3

Length (mm)	Dimensions (mm)	Thickness (mm)	Item no.	EAN
2600	600	50	4511929	4025345096224

## Qboard® qorner

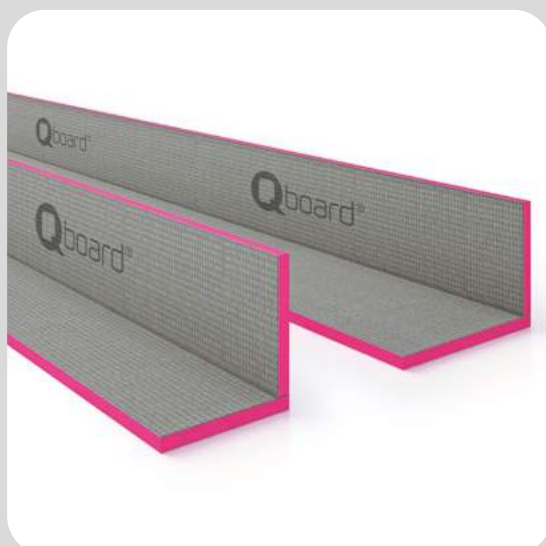

**Qboard® qorner** is the perfect angle element for quickly cladding pipes and conduits. Can be covered directly with tiles, filler or plaster.

Length (mm)	Dimensions (mm)	Thickness (mm)	Item no.	EAN
1200	150 x 150	20	4507369	4025345064780
1200	200 x 200	20	4507370	4025345064797
1200	300 x 300	20	4507371	4025345064803
1200	400 x 200	20	4507372	4025345064810
2600	150 x 150	20	4507373	4025345064827
2600	200 x 200	20	4507374	4025345064834
2600	300 x 300	20	4507375	4025345064841



### Qboard® single desq



Assembly kit consisting of:

- 2 side walls + 1 tabletop, 80 mm
- 1 centre shelf, 50 mm
- Special adhesive, screws
- Mounting boards, assembly instructions

Length (mm)	Depth (mm)	Height (mm)	Item no.	EAN
800	600	850	4507405	4025345065510

### Qboard® double desq



Assembly kit consisting of:

- 2 side walls + 1 tabletop
- 1 centre upright, 50 mm
- 2 centre shelves, 50 mm
- Special adhesive, screws
- Mounting boards, assembly instructions

Length (mm)	Depth (mm)	Height (mm)	Item no.	EAN
1600	600	850	4507406	4025345065527

### Qboard® small raq



Assembly kit consisting of:

- 2 side walls, 50 mm
- 5 shelves, 50 mm
- Special adhesive, screws
- Mounting boards, assembly instructions

Length (mm)	Depth (mm)	Height (mm)	Item no.	EAN
600	300	2125	4507407	4025345065497

### Qboard tall raq



Assembly kit consisting of:

- 2 side walls, 50 mm
- 4 shelves, 50 mm
- 1 shelf, 80 mm
- Special adhesive, screws
- Mounting boards, assembly instructions

Length (mm)	Depth (mm)	Height (mm)	Item no.	EAN
600	600	2125	4507408	4025345065503

## Qboard® qladd



**Qboard® qladd** is the prefabricated element with height-adjustable feet for easy bath panelling. Compact, super-light and can be covered directly with tiles, filler or plaster.

The height-adjustable feet also ensure a perfect fit on uneven substrates.

Length (mm)	Dimensions (mm)	Thickness (mm)	Item no.	EAN
1800	600	30	4507462	4025345065541
800	600	30	4507461	4025345065534

## Qboard® quick



Assembly kit

**Qboard® quick.** Special construction and tiling elements for cladding pre-wall elements for WCs. For all common toilet connections, drains.

### Assembly kit with 10 self-tapping screws and 10 insulation board discs

Length (mm)	Dimensions (mm)	Thickness (mm)	Item no.	EAN
1300*	600*	20*	4509708	4025345080957

\* dimensions per board, 1 board with cutout holes,  
2 boards without cutout holes



Construction board

### Construction board

Length (mm)	Dimensions (mm)	Thickness (mm)	Item no.	EAN
1300	900	20	4513638	4025345104943

**Qboard® liquid**



**Qboard® liquid.** The shower element with built-in fall and sealed drain flange for accessible showers. Qboard® liquid accessible, tileable shower elements are available in various designs. Customised shapes are available on request for even more freedom in shower design. You can freely choose the size and shape of the shower element and the position of the drain. However, the distance from the centre of the drain to the edge must be at least 250 mm.

Length (mm)	Width (mm)	Thickness (mm)	Item no.	EAN
900	900	40	4507376	4025345064858
1000	1000	40	4507379	4025345064889
1200	1200	40	4507382	4025345064919

Drain position: central ☐

1200 <sup>1</sup>	900	40	4508658	4025345073812
1400 <sup>2</sup>	900	40	4511903	4025345096040
1800 <sup>3</sup>	900	40	4509584	4025345080445

Drain position: off-centre

<sup>1</sup>450/400 ☐ <sup>2</sup>450/450 ☐ <sup>3</sup>650/450 ☐

**Qboard® liquid line**



1-sided fall

**Qboard® liquid line.** The tileable, accessible shower element with one-sided slope and integrated drainage channel made of brushed stainless steel. Stainless steel bar can be turned over and tiled on the back! Ideal for tile with 10 to 12 mm thickness. The length of the channel drain board can be cut to any size!

Length (mm)	Width (mm)	Thickness (mm)	Item no.	EAN
1200	900	60	4514034	4025345107579
1400	900	60	4511936	4025345096262
1600	900	60	4516946	4025345122343

1-sided fall  
Channel length: 750 mm

## Qboard® liquid line



4-sided fall

**Qboard® liquid line.** This easy-access, ready-to-tile shower tray with integrated drainage channel has four preformed slopes and can be adapted to the desired size. On the drainage channel, choose between a brushed stainless steel side or, on the reverse, a hollow side that can be painted after tiled. Ideal for tile with 10 to 12 mm thickness.

Length (mm)	Width (mm)	Thickness (mm)	Item no.	EAN
1400	900	50	4521659	4025345147643
1800	900	50	4521661	4025345147650

4-sided fall  
Channel length: 550 mm

## Qboard®



### Vertical drainage system

for Qboard® liquid and Qboard® liquid line shower elements. Drainage capacity 0.8 l/sec.

Item no.	EAN
4503078	4025345030785



### Horizontal drainage system

for Qboard® liquid and Qboard® liquid line shower elements. Drainage capacity 0.8 l/sec.

Item no.	EAN
4503077	4025345030778





## Metal dowels

- Dowel hole  $\varnothing$  8 mm
- For fixing Qboard® elements: 5 pcs/m<sup>2</sup>

Length (mm)	Item no.	EAN
80	4514590	4025345110005

(Quantity / VP = 10 pieces)



## Anchor brackets

- For fixing Qboard® corner

Internal dimension (mm)	Item no.	EAN
20	4513433	4025345104509

(Quantity / VP = 2 pieces)



## Insulation board discs

- Galvanised
- Required quantity: 5 pcs/m<sup>2</sup>

$\varnothing$ (mm)	Hole $\varnothing$ (mm)	Item no.	EAN
36	5	4513432	4025345104493

(Quantity / VP = 20 pieces)

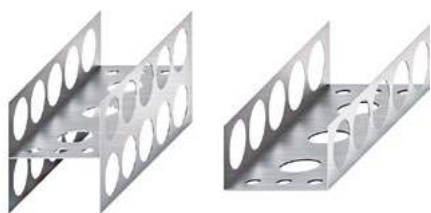

## H profiles | U profiles

- For fixing 50-mm-thick Qboard® basic construction boards
- Ideal for building partition walls

Internal dimension (mm)	Item no.	EAN
H 50	4512703	4025345100761
U 50	4512704	4025345100778

(Quantity / VP H profiles = 2 pieces; U profiles = 3 pieces)



## BOARD-FIX®

- Special adhesive and sealing agent for bonding the construction boards
- For sealing construction-board joints in wet areas
- One cartridge is sufficient for about 9 running metres

Contents (ml)	Item no.	EAN
290	4506342	4025345058659

## Glass-fibre tape

- For reinforcing the butt edges of construction boards
- Self-adhesive

Width (cm)	Roll length (m)	Item no.	EAN
12.5	25	4513437	4025345104530



## Sealing tape

- For sealing butt edges in wet areas
- With rubber coating in the centre

Width (cm)	Roll length (m)	Item no.	EAN
12	3	4513438	4025345104547
12	6	4514463	4025345109603



## Corners

- Prefabricated corners for easy sealing in wet rooms

Type	Item no.	EAN
Internal corner	4513436	4025345104523
External corner	4515710	4025345116175

(Quantity / VP = 2 pieces)

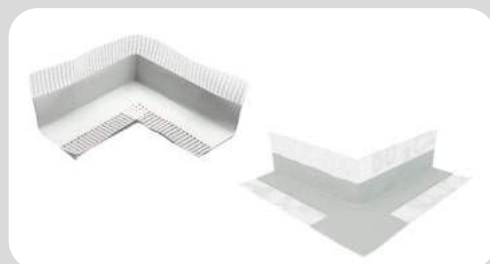

## Sealing collars

- For sealing holes through Qboard® construction boards for pipes

Item no.	EAN
4513434	4025345104516

(Quantity / VP = 2 pieces)

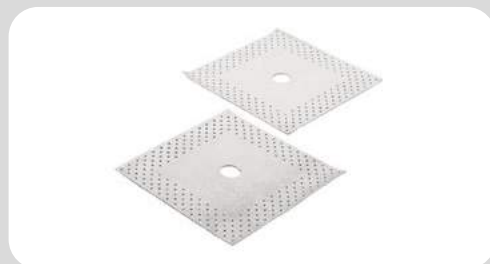

## Sealing set 2-K

- For completely tight construction-board joint seals in shower areas
- Coordinated set, for 10-m joint incl. 2 internal corners

Item no.	EAN
4511744	4025345094671





## Qboard® basiq

Properties		Standard	Unit	XPS core
Bulk density		EN 1602	kg/m <sup>3</sup>	> 30
Rated value, thermal conductivity $\lambda_D$		EN 13164	W/(m · K)	0.034 <sup>1</sup>
Compressive strength and/or compressive stress at 10 % compression		EN 826	N/mm <sup>2</sup>	> 0.30 <sup>2</sup>
Dimensional stability at 40 kPa pressure and 70 °C temperature load		EN 1605	%	≤ 5
Dimensional stability at 70 °C and 90% relative humidity		EN 1604	%	≤ 5
Vapour diffusion resistance factor $\mu$ (dependent on thickness)		EN 12086	-	60 - 200
Water absorption on long-term immersion		EN 12087	Vol-%	≤ 1
Linear thermal expansion coefficient		-	mm/(m · K)	0.07
Reaction to fire		EN 13501-1	Class	Euroclass E
Working temperature		-	°C	-50 / +75
Properties		Standard	Unit	Qboard® basiq
Tensile strength		EN 1607	kPa	≥ 200
Tolerances	Width	EN 822	mm	± 2
	Length	EN 822	mm	± 2
	Rectangularity	EN 824	mm/m	≤ 5
	Evenness	EN 825	mm	≤ 2
Edge profile		-	-	smooth

<sup>1</sup> at 80 mm  $\lambda_D = 0.035$  W/(m·K)

<sup>2</sup> 0.2 N/mm<sup>2</sup> for Qboard® basiq in 20 mm

### Information:

We would like to point out that the data, images, technical information and drawings provided in the brochure are general details and suggestions. The illustrations are schematic and demonstrate the basic functional principle. Exact dimensions are not specified. The fabricator/customer is responsible for testing the applicability with regard to the respective construction project. The technical specifications and data for the products in the installation instructions, technical data sheets and system descriptions/approvals must be observed. Due to the many different possible applications for Qboard® products, which cannot always be checked for correct following of installation instructions, handling and installation, JACKON Insulation GmbH shall only be liable for the data stated herein in accordance with licensing regulations.

The precise installation instructions and additional information can be found on our homepage [www.myqboard.com](http://www.myqboard.com).



# A BEAUTIFUL BATHROOM. SIMPLY DO IT!

- The construction board system for DIY enthusiasts
- Easy to work with
- The cement-coated surface is the perfect substrate for any coverings: tiles, plaster, filler, and so on ...
- 100% waterproof thanks to XPS core
- Many different design possibilities

[www.myqboard.com](http://www.myqboard.com)